



**STUDIO-ALCOVE | ST2-A**

STUDIO/ONE BATH

SQUARE FEET: 518

\*1<sup>ST</sup>-3<sup>RD</sup> FLOOR

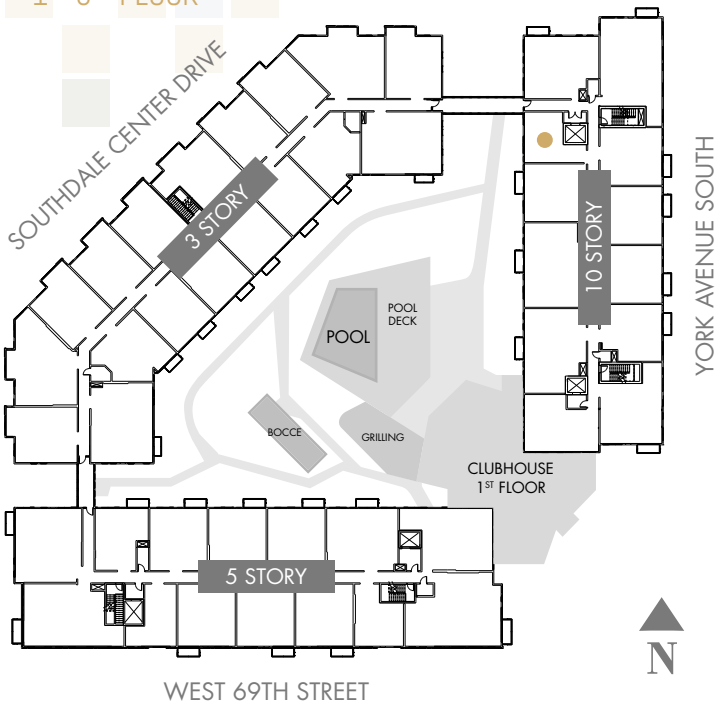

ONE DISTINGUISHED ADDRESS | ONE IMPECCABLE LIFESTYLE | ONE EXCEPTIONAL RESIDENCE

In our continuing effort to improve the design and function of our homes, we reserve the right to modify or change plans, specifications, features and prices without notice. All dimensions and sizes are approximate.



(952) 767-2972 | onesouthdale@stuartco.com | 6800 York Avenue South, Edina, MN 55435

